

**YOUR NAME** \_\_\_\_\_

Start at the **FONT** then follow the numbers from **1-15**

**1 FONT**

A font is used for baptism (christening).

What is put in it for a baptism?

W \_ \_ \_ \_



How many sides does it have? \_\_\_\_\_

Is this shape  an **octagon** or a **hexagon**?

circle the answer

**2 LECTERN**

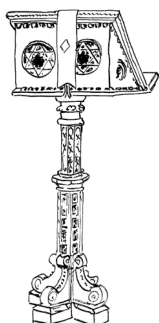

A lectern is a reading desk.

What are the three letters on the bookmark?

\_\_\_\_\_

This is a short way of writing Jesus in Greek. As you go round look out for these letters looking like this:

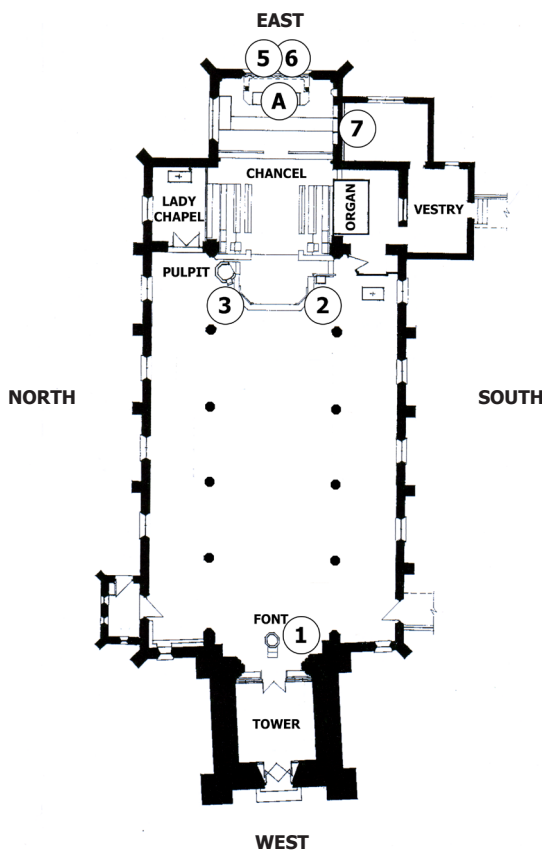

**4 MOVABLE ALTAR**

An altar is a Holy Table. The High Altar is marked on the plan with an **A**. There is also a movable Altar. Try to find it.

It has five crosses on the top. What are the words on the front of this altar?

\_\_\_\_\_

\_\_\_\_\_

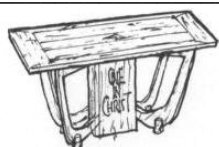

**5 EAST WINDOW I**

Look at the stained glass window above the High Altar. The window shows Jesus' crucifixion. What are the letters above his head?

\_\_\_\_\_

What creature can you see at the foot of the tree/cross?

The letters stand for IESUS NAZARENUS REX IUDAEORUM. This means Jesus of Nazareth King of the Jews in Latin.

**6 EAST WINDOW II**

The bottom part of the East Window shows symbols of the four Evangelists, the writers of the gospels.

Find their symbols:

Matthew's – a winged man

Luke's – a winged ox

John's – an eagle

Mark's – a winged ...?



**3 PULPIT**

What is the pulpit used for?

\_\_\_\_\_

\_\_\_\_\_

Why is it so high?

\_\_\_\_\_

\_\_\_\_\_



**7 NATIVITY WINDOW**

Look at the window to the right of the High Altar.

What is the name of the baby?

\_\_\_\_\_

What animals can you see?

\_\_\_\_\_

\_\_\_\_\_

\_\_\_\_\_



### 8 CHEST MEMORIAL

To the left of the High Altar is a large stone chest. There is a coat of arms on both ends.

Is the bird on the coat of arms:

an eagle / a dove / a swan / a pelican

circle the answer

### 9 CHANCEL FLOOR TILES

The floor tiles in this part of the Church have different patterns. Draw one of the patterns here:

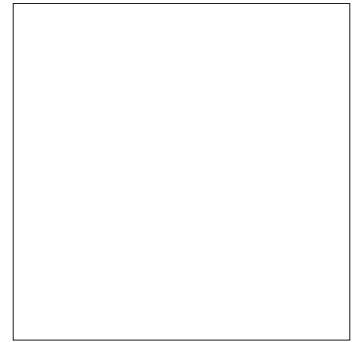

### 10 STONE MEMORIAL

In the Lady Chapel is a broken stone with writing on it set into the wall. The stone was erected in memory of a Thomas and Tabitha Fotherley. They had one son, Thomas and two daughters. What were the daughters' names?

\_\_\_\_\_

### 11 KNEELERS

The kneelers have different patterns, some have a single large letter. What is the letter and what does it stand for?

Letter: \_\_\_\_\_

### 12 STATIONS OF THE CROSS

Along both of the side walls are 14 pictures which tell the story of Jesus' journey which ended in his death.

Follow his journey and make a cross (†) in the box for every cross or part of a cross you see in the pictures.



The cross is the main Christian symbol or sign.

### 13 ORGAN

Find the organ.

The size of the pipes changes the sound. Which pipes do you think make the lower notes?

Short  or Tall?

### 14 BRASS MEMORIAL

Find the brass memorial to Thomas Day. Thomas had two wives, one after the other: what were their names?

1. \_\_\_\_\_ 2. \_\_\_\_\_

Both wives have special collars. What are they called?

\_\_\_\_\_

### 15 TOWER

Go outside the Church and look at the tower.

There are three dates carved into the stonework. Remember to look up as well as down.

What is the earliest date?

\_\_\_\_\_

What are the other dates?

\_\_\_\_\_

\_\_\_\_\_

The Tower is the oldest part of the church building.

